



Polycarbonate Door Kit for Polaris RS1

Read through all instructions before install.

- | | |
|--|---|
| 5 – Bolt $\frac{1}{4}$ -20 \times 1" | 2 – $\frac{1}{4}$ " Clip Nut |
| 2 – Bolt $\frac{1}{4}$ -20 \times 1.25" | 2 – Threaded Nut Insert |
| 3 – Locknut $\frac{1}{4}$ " | 1 – $\frac{9}{32}$ " Drill Bit |
| 7 – Flat Washer $\frac{1}{4}$ " | 1 – Bottom Bulb Seal ($1\text{-}3/16$ " |

STEP ONE – Open up the ignition side panel by unscrewing 5 screws in the side panel. Caution: When opening/removing factory panels the clip on nuts inside can become dislodged and lost in the abyss of the machine. Replace the two factory clip on nuts for screws circled in yellow with the two $\frac{1}{4}$ " clip on nuts provided. Screw the removed factory screws back into the screw holes except for the two with replaced clip on nuts.

STEP TWO – Start the two back bolts of the side panel using 1.25" long bolts. Put a flat washer on each bolt before inserting the bolt. Don't over tighten the bolts.



STEP THREE – Align side insert to desired position and mark location for the plastic insert nuts. Remove side insert to place the captive nuts. Drill holes using included drill bit. Use a hex head wrench to screw insert nut into the plastic.

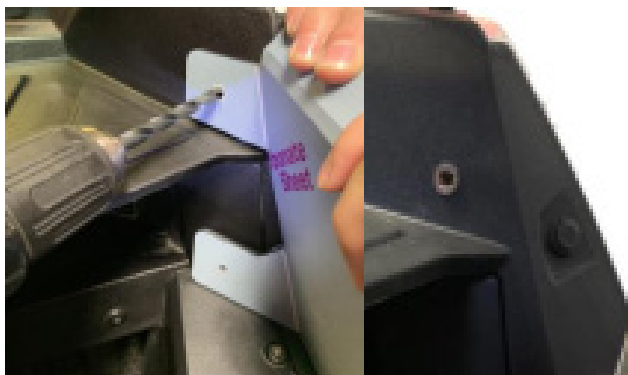
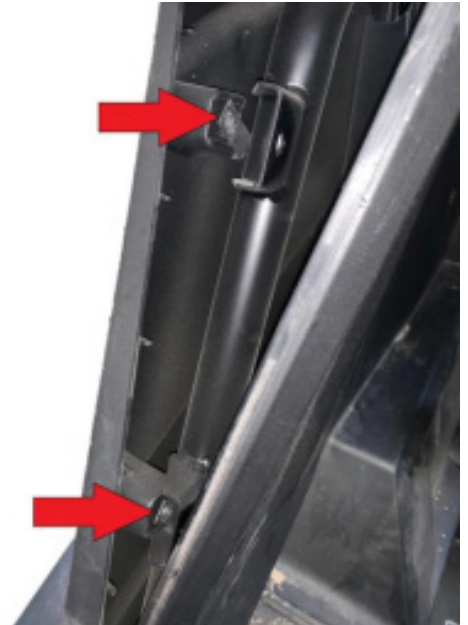

STEP FOUR – Put the side insert in place, using 1" bolts and washers, by bolting the front two tabs to the machine. Bolt the two rear bolts and tighten all bolts. Caution: Over tightening bolts could cause the plastic insert nuts to strip free or the polycarbonate to crack.

STEP ONE – Remove the outer door panel by unscrewing 7 screws. Caution: When opening/removing factory panels the clip on nuts inside can become dislodged and lost

STEP TWO – Bolt door insert to door frame using 1” long bolts at locations circled in red. Put a flat washer on each bolt before inserting. Don’t tighten the bolts until all 3 bolts are started in the lock nut and holding the door insert in position. **Caution:** Over tightening bolts could cause the polycarbonate to crack.



STEP THREE – Bolt the door panel back to the frame matching three of the holes with the holes in the door insert.

STEP FOUR – Attach edge trim, as seen in the picture, to prevent rattling and protect plastics.

Picture 2: The factory screws to remove. Picture 3: The nut plates in the right place. Picture 4-5: Plastic Insert Nut Locations

STEP THREE – Attach edge trim, as seen in the picture, to prevent rattling and protect plastics.

Picture 2: The factory screws to remove. Picture 3: The nut plates in the right place. Picture 4-5: Plastic Insert Nut Locations Picture 6: Location of three bolts on door panel Picture 7: Edge Trim Location



PRO TIPS

*When installing bolts use a small amount of **blue** thread locker, such as Loctite. This will keep the bolts from backing out during use. Tinted polycarbonate can scratch easily. It is recommended to wait until you finish your ride to clean the vent covers. Use mild cleaners such as windex with a new, unused, micro fiber cloth. Paper towels will scratch the polycarbonate. Do not apply pressure during the cleaning process or you may scuff the polycarbonate*